

2024 LUXURY MOTORCOACH

# L O N D O N A I R E





# The lap of luxury is even more apparent, now.

The luxurious London Aire is all-new for 2024. Now it's loaded with even more comfort and stress-reducing technology that makes travel even easier. More than that, the newly designed exterior and stylistic changes throughout the coach are bound to turn heads across your entire road trip.



# London Aire

# Spartan® K3 Tag Axle Chassis



45' / 5 floor plans

Cummins X  
Diesel Engine  
605 HP  
1950 lb./ft. torque  
York Full-Paint  
Masterpiece Finish™  
Exterior



# Cockpit

## Redesigned Dash\*

### Heated Driver and Passenger Seats

Power Lumbar, Recline, and Footrest  
Passenger Seat Workstation

### Industry-First Comfort Drive™ Adaptive Steering

### Mobileye® Lane Tracking and Departure System

### OnGuard™ Collision Mitigation Adaptive Cruise System

Adjustable Following Distance Control

### Electronic Stability Control

### Digital Glare-Free Dash

#### Xite Dash Radio

10" Dual Monitor  
Nav-N-Go Navigation System  
Apple CarPlay®  
HD 360 Camera System  
Predictive Grid Lines  
Tri-View Rear Camera

### Passenger-Side Monitor (Optional)

### Push Button Start

### Wireless Charger Mats

\*New for 2024





Floor plan 4551 with Balboa décor and Bermuda cabinets

# Cabin

**Four Décor Options\*:  
Balboa, Harrison, Montara, and Wentworth**

**Side Hide-a-Bed Sofa and Jack Knife Sofa\*\***

**50" Samsung® 4K LED TV on Televator**

Bose® 900 Soundbar

Bose® 500 Subwoofer

43" Samsung® 4K LED in Front Overhead

**Porcelain Floors\***



\* Newly styled for 2024

\*\* See Features & Options for all available furniture configurations

# Cabin

**Slideout Fascia and Feature Ceiling\***

**Wall Sconces\***

**Three 15K BTU Penguin™ Heat Pump  
Central Air Conditioners**

**Electric Radiant Heat Beneath Main  
Floor Tile**

**WiFiRanger Denali System  
with Spruce Router**



Floor plan 4551 with Balboa décor and Bermuda cabinets



# Galley & Dinette

**19.7 Cu. Ft. Whirlpool® Refrigerator**

**Stainless Convection Microwave**

**All-Electric Recessed Mount Induction Cooktop**

**Stainless Front Dishwasher in Drawer** (Optional)

**Glazed Maple Hardwood Cabinets\***

Available in Four Matte or High Gloss Finish Color Options

Soft-Close Cabinet Doors

Undermounted LED Lights

**Large Pantry**

Pull-Out Shelves

Push-to-Release Drawer Slides

Dedicated Serving Tray and Bakeware Space

Undermounted LED Lights

**Super-Polished Solid-Surface Countertops**

**Tile Backsplash\***

**Kitchen Window** (Optional)

**Hide-a-Leaf Dinette\*\***



\* Newly styled for 2024

\*\* Additional dinette configurations available; see Features & Options for details







# *Bedroom*

## **King-Size Bed with Pillow Top Mattress**

Adjustable Support Air Bed (Optional)

## **Lighted Wardrobe**

Dedicated Shoe Storage  
Safe

## **Samsung® LED TV**

Swing-Out Mount

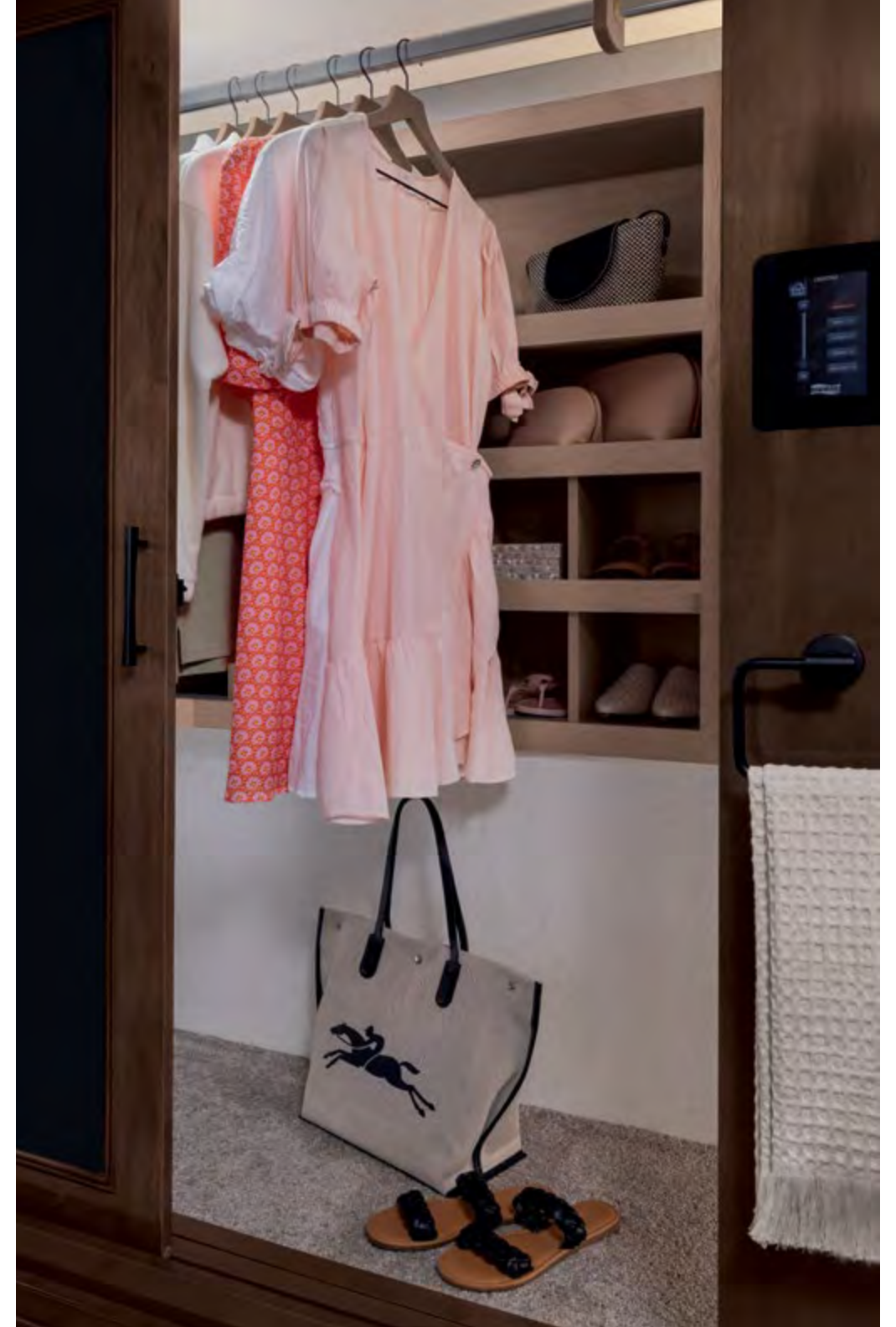

# Bathroom

## Midship Bath

Fully Tiled Shower Walls & Floor\*\*1

Vanity, Backsplash, and Hardware\*\*

Aqua Miser® Shower System

Dual-Sink Vanity\*

Splendide® Two-Piece Stacked  
Washer and Dryer

Super-Polished Solid-Surface  
Countertop

Cathedral Ceiling for Added Height  
(Rear Bath Floor Plans)

Linen Cabinet





# Exterior & Storage

**Industry-Exclusive Full-Paint Masterpiece Finish™ with Cut and Buff**

New Exterior Design with Four Color Combinations\*  
New Front and Rear Cap\*

**Girard® Nova Side Awnings**

**Lighted Front Grill Newmar Badge**

**SilverStar Ultra Headlight Bulbs**

**Basement Storage**

Easy-Close Doors

**3.0 Cu. Ft. Dometic® Freezer on Pull-Out Tray**

**Exterior Entertainment Center (Optional)**

43" Samsung® 4K LED TV

Bose® Soundbar

\*New for 2024



# Exterior

## **Lithium Ion Battery System** (Optional)

Two Lithionics 320 AHR Battery Packs  
Surge Guard Transfer Switch

## **Industry-Exclusive STAR Foundation**

## **12.5 kW Cummins Onan® Diesel Generator**

**10 Watt Solar Panel**  
(to Charge Chassis Battery)



*interior & exterior*  
*Design Options*



# Birmingham



Awning Color: Charcoal Tweed

## BALBOA INTERIOR a. Furniture/Fabric b. Flooring c. Counter Top



\*Exterior colors and interior décor options can be matched to customer preference.

## CABINET FINISHES



\*Available in Matte or High Gloss Finish

# Cambridge



Awning Color: Linen Tweed

## HARRISON INTERIOR

a. Furniture/Fabric b. Flooring c. Counter Top



## CABINET FINISHES



\*Exterior colors and interior décor options can be matched to customer preference.

\*Available in Matte or High Gloss Finish

# Newry



Awning Color: Charcoal Tweed

**MONTARA INTERIOR** a. Furniture/Fabric b. Flooring c. Counter Top



*\*Exterior colors and interior décor options can be matched to customer preference.*

**CABINET FINISHES**



*\*Available in Matte or High Gloss Finish*



# York



Awning Color: Charcoal Tweed

**WENTWORTH INTERIOR** a. Furniture/Fabric b. Flooring c. Counter Top



**CABINET FINISHES**



*\*Exterior colors and interior décor options can be matched to customer preference.*

*\*Available in Matte or High Gloss Finish*



# Floor Plan Specifications



Length: 44' 10"

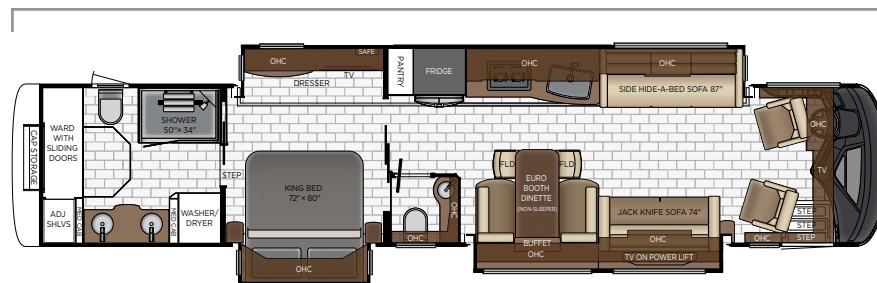

|             |                     |         |             |            |
|-------------|---------------------|---------|-------------|------------|
| <b>4521</b> | Length              | 44' 10" | Grey Tank   | 80 gal.    |
|             | Width               | 101.5"  | Sewage Tank | 60 gal.    |
|             | App. Overall Height | 13' 04" | Water Tank  | 105 gal.   |
|             | Interior Width      | 95.5"   | Furnace     | 50,000 btu |
|             | Interior Height     | 83"     |             |            |

Length: 44' 10"

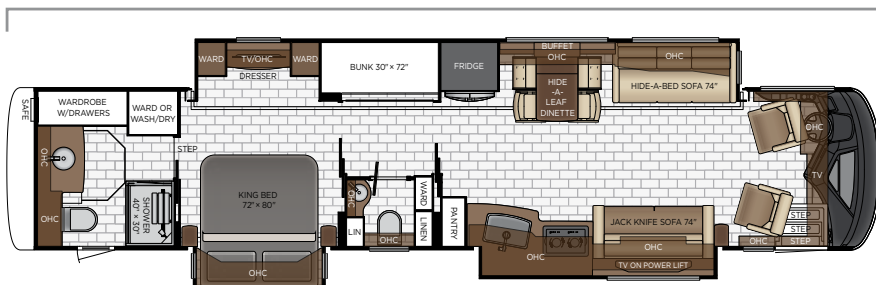

|             |                     |         |             |            |
|-------------|---------------------|---------|-------------|------------|
| <b>4535</b> | Length              | 44' 10" | Grey Tank   | 80 gal.    |
|             | Width               | 101.5"  | Sewage Tank | 60 gal.    |
|             | App. Overall Height | 13' 04" | Water Tank  | 105 gal.   |
|             | Interior Width      | 95.5"   | Furnace     | 50,000 btu |
|             | Interior Height     | 83"     |             |            |

Length: 44' 10"

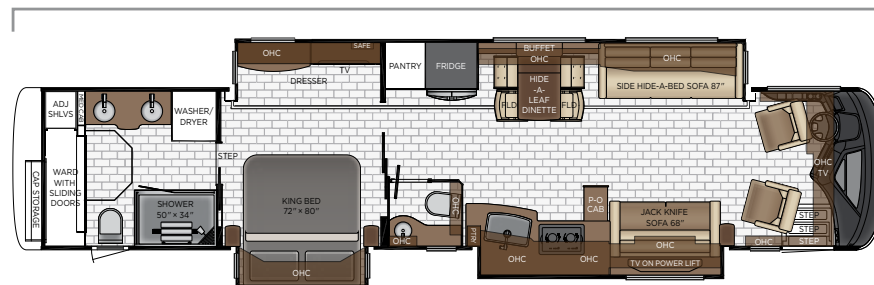

|             |                     |         |             |            |
|-------------|---------------------|---------|-------------|------------|
| <b>4551</b> | Length              | 44' 10" | Grey Tank   | 80 gal.    |
|             | Width               | 101.5"  | Sewage Tank | 60 gal.    |
|             | App. Overall Height | 13' 04" | Water Tank  | 105 gal.   |
|             | Interior Width      | 95.5"   | Furnace     | 50,000 btu |
|             | Interior Height     | 83"     |             |            |

Length: 44' 10"

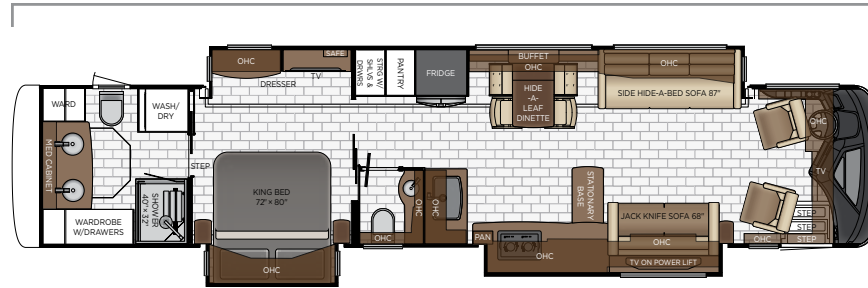

|             |                     |         |             |            |
|-------------|---------------------|---------|-------------|------------|
| <b>4569</b> | Length              | 44' 10" | Grey Tank   | 80 gal.    |
|             | Width               | 101.5"  | Sewage Tank | 60 gal.    |
|             | App. Overall Height | 13' 04" | Water Tank  | 105 gal.   |
|             | Interior Width      | 95.5"   | Furnace     | 50,000 btu |
|             | Interior Height     | 83"     |             |            |
|             |                     |         |             |            |

Length: 44' 10"

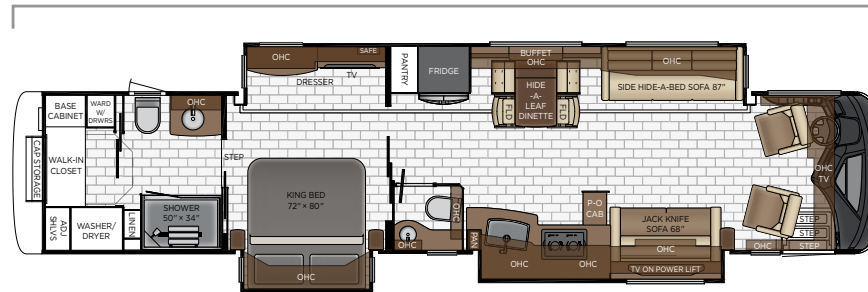

|             |                     |         |             |            |
|-------------|---------------------|---------|-------------|------------|
| <b>4579</b> | Length              | 44' 10" | Grey Tank   | 80 gal.    |
|             | Width               | 101.5"  | Sewage Tank | 60 gal.    |
|             | App. Overall Height | 13' 04" | Water Tank  | 105 gal.   |
|             | Interior Width      | 95.5"   | Furnace     | 50,000 btu |
|             | Interior Height     | 83"     |             |            |
|             |                     |         |             |            |

# Quality You Can Feel

Like a fine home, the 2024 London Aire is framed 16 inches on center, and is covered by a fiberglass roof with an integrated gutter rail.

| SPARTAN*   |           |            |           |            |            |           |           |           |           |           |          |
|------------|-----------|------------|-----------|------------|------------|-----------|-----------|-----------|-----------|-----------|----------|
| FLOOR PLAN | ENGINE HP | AXLE RATIO | FUEL CAP. | WHEEL BASE | FRONT GAWR | REAR GAWR | TAG GAWR  | GVWR      | GCWR      | APP. UVW  | APP. NCC |
| 4521       | 605       | 4.3        | 150       | 292+TAG    | 20000 lb.  | 20000 lb. | 14000 lb. | 54000 lb. | 74000 lb. | 45700 lb. | 8300 lb. |
| 4535       | 605       | 4.3        | 150       | 292+TAG    | 20000 lb.  | 20000 lb. | 14000 lb. | 54000 lb. | 74000 lb. | 46300 lb. | 7700 lb. |
| 4551       | 605       | 4.3        | 150       | 292+TAG    | 20000 lb.  | 20000 lb. | 14000 lb. | 54000 lb. | 74000 lb. | 45800 lb. | 8200 lb. |
| 4569       | 605       | 4.3        | 150       | 292+TAG    | 20000 lb.  | 20000 lb. | 14000 lb. | 54000 lb. | 74000 lb. | 45900 lb. | 8100 lb. |
| 4579       | 605       | 4.3        | 150       | 292+TAG    | 20000 lb.  | 20000 lb. | 14000 lb. | 54000 lb. | 74000 lb. | 46200 lb. | 7800 lb. |

**The content in our literature depicts and describes products that are subject to change. For the most recent images and information, please visit [NewmarCorp.com](http://NewmarCorp.com).**

Lengths, heights, widths, and dry weights are approximate. Weight will vary based on optional equipment added to the above base weight.

**GAWR:** Gross Axle Weight Rating is the maximum permissible weight for an axle.

**GVWR:** Gross Vehicle Weight Rating is the maximum permissible weight for a fully loaded motor coach.

**GCWR:** Gross Combination Weight Rating is the value specified by the manufacturer of the vehicle as the maximum allowable loaded weight of this motor coach and any towed trailer or towed vehicle.

**UVW:** Unloaded Vehicle Weight is the weight of this motor coach as built at the factory with full fuel, engine oil, and coolants. Does not include cargo, fresh water, propane gas, or dealer-installed accessories.

**NCC:** Net Carrying Capacity is the maximum weight of all occupants, including the driver, personal belongings, food, fresh water, waste water, propane gas, tools, tongue weight of towed vehicle, dealer-installed accessories, etc., that can be carried by the motor coach.

**Specifications supplied by the chassis manufacturer.**

**London Aire R-Values:**

Roof R-Value = 19

Sidewall R-Value = 11

Floor R-Value = 16

Basement R-Value = 4



# Features & Options



## EXTERIOR FEATURES

Full-Paint Masterpiece Finish™ with Cut and Buff and Beta Fusion Protection on Front Cap

Lighted Newmar Badge in Front Grill

Convex Exterior Chrome Mirrors with Remote Control, Defrost, Turn Signals and Side-View Cameras

Entrance Door with Automatic Step

Rear Hitch for Towing Car

Assist Handle at Entrance Door

Mud Flaps

Rear Protective Tow Guard with Stainless Steel Newmar Name Cutout

Undercoating

Hydraulic Leveling Jacks

Stainless Steel Exterior Trim Pieces and Entrance Door Kick Panel

Storage Bins in Pegboard Compartment

Storage Shelf Above Freezer

Chrome Power Baggage Door Locks, Keyless Entrance Door with Touch Pad and Door Bell

### OPTIONS

Stainless Steel Trim Kit for Exterior Compartment Doors

Flag Pole Bracket

Storage Tray 26 X 90 Power with Shelf in Top of Compartment, Location-Bay 2

Storage Tray 26 X 91 Non-Power with Shelf in Top of Compartment, Location Bay 2

Storage Tray 40 X 90 Power with Shelf in Top of Compartment, Location-Bay 3

Storage Tray 42 X 91 Non-Power with Shelf in Top of Compartment, Location-Bay 3

Storage Tray 43 X 56 Non-Power, Location-Bay 4

## CONSTRUCTION FEATURES

Fiberglass Roof and Integrated Gutter Rail

Gelcoated Fiberglass Exterior Sidewalls, Front and Rear Caps

Aluminum-Frame Sidewalls and Roof Construction, 16" on Center

5/8" Foam Insulation Laminated in Sidewalls and Ceiling

Polar Pak R19 Batten Insulation on Roof

Automatic Mechanical Lock Arms on Non Hydraulic Slideout Rooms-Paddle Style

Egress Door with Ladder System

## WINDOWS, AWNINGS, & VENTS

Frameless Double-Pane Tinted Safety-Glass Windows

Fan-Tastic® Vent with Rain Sensor in Kitchen, Bathroom and Enclosed Stool Room

Hardwood Louvered Cover on Fan-Tastic® Vent in Kitchen

Skylight Above Shower\*

Girard® Package-Two Nova Side Awnings, Slideout Covers, Entrance Door and Power Window Awnings

Large Non-Ventilated Living Room and Dinette Windows

One-Piece Tinted Windshield

Driver Side Power Window

Bunk Windows

### OPTIONS

Kitchen Window

## CHASSIS FEATURES

Air Leveling Control System

Aluminum Wheels

Electronic Chassis Information Center in Dash

Electronic Stability Control

Cruise Control

Comfort Drive™ Steering with Power Column with Adjustable Control

Recessed Fuel Fills with Crossover to Fill from Either Side

Back-Up Alarm

Anti-Lock Braking System

Chassis Battery Disconnect

Blind Spot Detection

Automatic Headlights On/Off

Push Button Engine Start

Glass Dash Instrument Panel

OnGuard™ Collision Mitigation Adaptive Cruise System with Adjustable Following Distance Control on Spartan® Chassis

Spartan® K3 Tag Axle, 605Hp on 45' London Aire

Tire Pressure Monitoring on Tag Axle Chassis

Mobilitye® Lane Tracking and Lane Departure Warning System

Steering Wheel Nine Function Switch Pod in Center on Spartan® Chassis

Tank Dump Side Tilt Mode

Trailer Tow Mode

Valid Digital Glare Free Dash on Spartan® Chassis

Valor Generation 3 TPMS System on Spartan® Chassis

KONI Shocks on All Axles

### OPTIONS

Curt Spectrum Integrated Brake Control on Spartan® Chassis

## AIR CONDITIONING & HEATING

Three 15K BTU Penguin™ Heat Pump Central Air Conditioners with Remote Control Thermostat

Chinook Dual Loop Heat with Continuous Hot Water

Dash Heater and Air Conditioner



Driver and Passenger Dash Overhead Ventilation System  
 Wall Mounted Sensors for Heating and Air Conditioning  
 Roof Air Conditioning Drainage System  
 Electric Radiant Heat Installed Below Main Floor Tile

## ELECTRICAL FEATURES

12.5 kW Cummins Onan® Diesel Generator  
 Generator Start/Stop Function on Touchscreen in Water Bay Compartment  
 10 Watt Solar Panel to Charge Chassis Battery  
 50 Amp Electrical Service with Flexible Cord with Automatic Transfer Switch  
 Eight 6-Volt AGM House Batteries  
 Battery Disconnect Switch for House Battery  
 3000 Watt True Sine Inverter  
 12 Volt Auxiliary Receptacle on Dashboard  
 Emergency Engine Start Switch  
 Engine Block Heater  
 Energy Management System  
 Exterior Security Lights  
 Midship Side Turn Signals  
 LED Lights Recessed in Ceiling and Underneath Overhead Cabinets  
 LED Lighting in Pull-Out Pantry, Kitchen and Bathroom Base Cabinets  
 Accent Lights in Feature Ceiling, Slideout Fascia Trim and Lambrequins  
 LED Lights in Exterior Storage Compartments on Automatic Switches, Controlled by an Interior Master Switch  
 LED Lights Installed Below Under Door Side Slideouts  
 Lights in Wardrobes  
 Manually Operated Hold-To-Run Slideout Switch  
 Automatic Generator Start on Low Battery or Temperature Setting  
 Cable TV Connection  
 Interior Courtesy Lights  
 USB Outlet at Dinette and Bedroom Night Stand  
 USB Outlet at Dash for Driver Use  
 110 Volt/USB Outlet at Head of Each Bunk Area\*  
 110 Volt Recept in Bed Overhead with Two Pass-Through Ports  
 KIB Touch Screen Interior Light and Shade Controls  
 Power Rewind Wheel with 50' Cord\*  
 Recessed Docking Lights  
 Reading Lights at head of Bed-Dimmable with Adjustable Aim

Secondary Multiple Touch Screen in Bedroom  
 Silverleaf® Multiplex Electrical Wiring System  
 Rozie Remote Internet Connection for Silverleaf® Multiplex System  
 System Control App to Control Numerous Features from Personal Device  
 Lighted Vanity Mirrors  
 Solar Prep with Six Gauge Wire from Roof to House Battery Compartment  
 Spare Fuses in Chassis and House Fuse Panels  
 Wireless Phone Charger Pad in Driver Area  
 Wireless Charging Mat Built into Passenger Console  
 Transfer Switch with Surge Protector  
 Dash Radio, Cameras and Monitors to Power-Up from both House Batteries and Ignition  
 Combo USB/USB-C Charging Port in Dash

## OPTIONS

LED Strip Lighting Installed Under Off Door Sideouts  
 Four Flexible 110 Watt Solar Panels on Roof  
 30 Amp/120 Volt Cord Connection for Stacker Trailer  
 Lithium Ion 640 AHR Battery System with Two 3000W Pure Sine Inverters  
 Lithium Ion 960 AHR Battery System  
 Remote Power Switch in Front Overhead Cabinet for Lithium Ion Battery System

## PLUMBING & BATH FEATURES

Demand Water System  
 Sewage Holding-Tank Rinse  
 Dometic® 321 China Bowl Stool or Macerator Stool\*  
 Tied Shower Walls with Glass Door  
 Fold-Down Shower Seat  
 Water Filter for Entire Unit  
 Exterior Shower  
 Auto Fill for Fresh Water Tank  
 Power Water Hose Reel  
 Grey Holding Tank Rinse  
 Aqua Miser® Shower System  
 Hot Water Line to Generator Area\*  
 Bladder Tank for Water Pump System

## OPTIONS

Assist Handle in Each Shower  
 RV Sanicon Turbo System

## INTERIOR FEATURES

Designer Feature Ceiling and Cathedral Ceiling with Added Height on Rear Bath Floor Plans\*

Tile Floor in Kitchen, Bathroom, Bedroom and Living Area

Auto Motion Power Window Shades and Lambrequins

Auto Motion Power Shades for Windshield and Driver/Passenger Side Windows

Hardwood Raised Panel Interior Passage Doors

Flush Handles on Swinging Bath Doors

Maximized Shoe Storage Shelves Recessed into Rear of Wardrobe\*

Interior Assist Handle at Main Entry Door

Fitted Non-Quilted Bedspread with Accent Pillows

Safe Located in Bedroom Wardrobe

Wastebasket in Kitchen Base Under Sink

Interior Passage Door Hardwood Raised Panel

## CABINETS & FURNITURE

Bermuda Glazed Maple Hardwood Cabinets with Raised Panel Doors and Matte Finish

Concealed Hinges on Cabinet Doors

Super-Polished Solid-Surface Countertop in Bathroom and Bedroom

Super-Polished Solid-Surface Countertop in Kitchen with Under Mounted Silgranit Sink and Sink Covers

Lifts on Bed Top

Passenger Seat Work Station

Pull-Out Pantry Shelves\*

Push-to-Release Drawer Slides in Pantry

Pantry with Space for Serving Trays and Bakeware

Drawers with Dove Tail Side and Self-Closing Full Extension Self-Closing Guides

Soft-Close Cabinet Doors\*

Villa Ultra Leather Sofa and Driver/Passenger Seats with Integrated Seat Belts

Heated Front Seats with Power-Lumbar, Recline, Footrest and Standard Width Passenger Seat

Plush Pillow Top Mattress

Extended Rotation Concealed Hinge for Washer and Dryer Cabinet Door

Side Folding Hide-A-Bed Sofa with Memory Foam Mattress\*

Mesh Cell Phone Holder at Each Bunk Bed\*

Full Height Wardrobes Beside Lav\*

Molded Silverware Divider Tray

Driver Seat with Vibrator for Haptic Feedback

Dinette Euro Booth with Two Table Leaves and Two Folding Chairs\*

Cooktop Cover Flush, Matching Countertop Material

## OPTIONS

Glacier Glazed Maple Hardwood Cabinets with Mitered Raised Panel Doors-High Gloss or Matte Finish

Bermuda Glazed Maple Hardwood Cabinets with Raised Panel Doors with High Gloss Finish

Driftwood Glazed Maple Hardwood Cabinets with Raised Panel Doors-High Gloss or Matte Finish

Sable Maple Hardwood Cabinets with Raised Panel Doors-High Gloss or Matte Finish

R5 Radius Corner Air Mattress

Power Extenda Flex Dinette

Convertible Dinette with Two Fixed and Two Folding Chairs

Euro Booth Dinette with Two Table Leaves and Two Folding Chairs

Combination Desk with Buffet Table, Two Fixed and Two Folding Chairs

One Large Ottoman

Two Recliners with Lampstand and Reading Lights

Queen-Size Passenger Seat

Powered Theater Seating 74"

Powered Theater Seating 87"

## APPLIANCES & ACCESSORIES

Stainless Steel 30" Convection Microwave with Air Fryer Feature

All Electric Cooktop Flush Mount Induction

Air Horns

Whirlpool® 19.7 Cu. Ft. Refrigerator

Splendide® Two-Piece Stacked Washer and Dryer

Dometic® 3.0 Cf Freezer on Pull-Out Tray in Exterior Baggage Compartment\*

Storage Above Freezer

Central Vacuum with Tool Kit

## OPTIONS

Dishwasher in Drawer with Stainless Steel Front

## AUDIO, VIDEO & ACCESSORIES

Samsung® LED TV Living and Bedroom Areas (TV Sizes Vary Per Floor Plan)

Samsung® 50" 4K LED TV on Televator in Living Area\*

Samsung® 43" 4K LED TV in Front Overhead

Bose® 500 Subwoofer

Bose® 900 Sound Touch Soundbar in Livingroom

Rearview Color Monitor System with Audio

\*Check with dealership on floor plan availability

|   |
|---|
| Winegard Rayzar Automatic Digital TV Antenna  |
| Satellite Dish Prep on Roof   |
| Radio SiriusXM® Capability with Antenna (Does Not Include Monthly Subscription)                           |
| Two Bedroom Radio Speakers  |
| TV Jack and 110 Volt Recept in Door Side Exterior Storage Compartment                                     |
| Cat 6 TV Cables   |
| Infrared Repeater System to Operate Audio/Visual Components   |
| WiFiRanger Denali/Spruce LTE  |
| Xite Dash Radio with Apple CarPlay®, 10" Dual Monitor with Nav-N-Go Navigation System                     |
| Xite HD 360 Camera System with Predictive Grid Lines and Tri-View Rear Camera                             |
| 10 Bc Fire Extinguisher, Smoke Detector, Propane and Carbon Monoxide Detector                             |
| <b>OPTIONS</b>  |
| Exterior Entertainment Center in Sidewall with Samsung® 43" 4K LED TV and Soundbar                        |
| Exterior Entertainment Center in Storage Compartment with Samsung® 43" 4K LED TV and Bose® Soundbar       |
| Two-19" Skyworth TV/DVD Monitors*   |
| Extra Monitor on Passenger Side   |
| Rear Camera (2) Prep for Use with Stacker Trailer   |
| Universal Toll Module   |
| WiFi System Everest with Aspen Interior Router  |
| Winegard Automatic Open Face Satellite Dish-for DISH HD and Bell HD TV                                    |
| Winegard Automatic Open Face SWM Satellite Dish-for DIRECTV Std/HD and In-Motion DIRECTV Std, DISH Std/HD |
| Winegard Automatic Open Face Satellite Dish and Winegard In-Motion for DISH Network                       |
| Winegard Automatic Open Face Satellite Dish-for DIRECTV   |
| Winegard In-Motion Dome Satellite Dish-for DISH Std/HD, DIRECTV Std and Bell Canada                       |



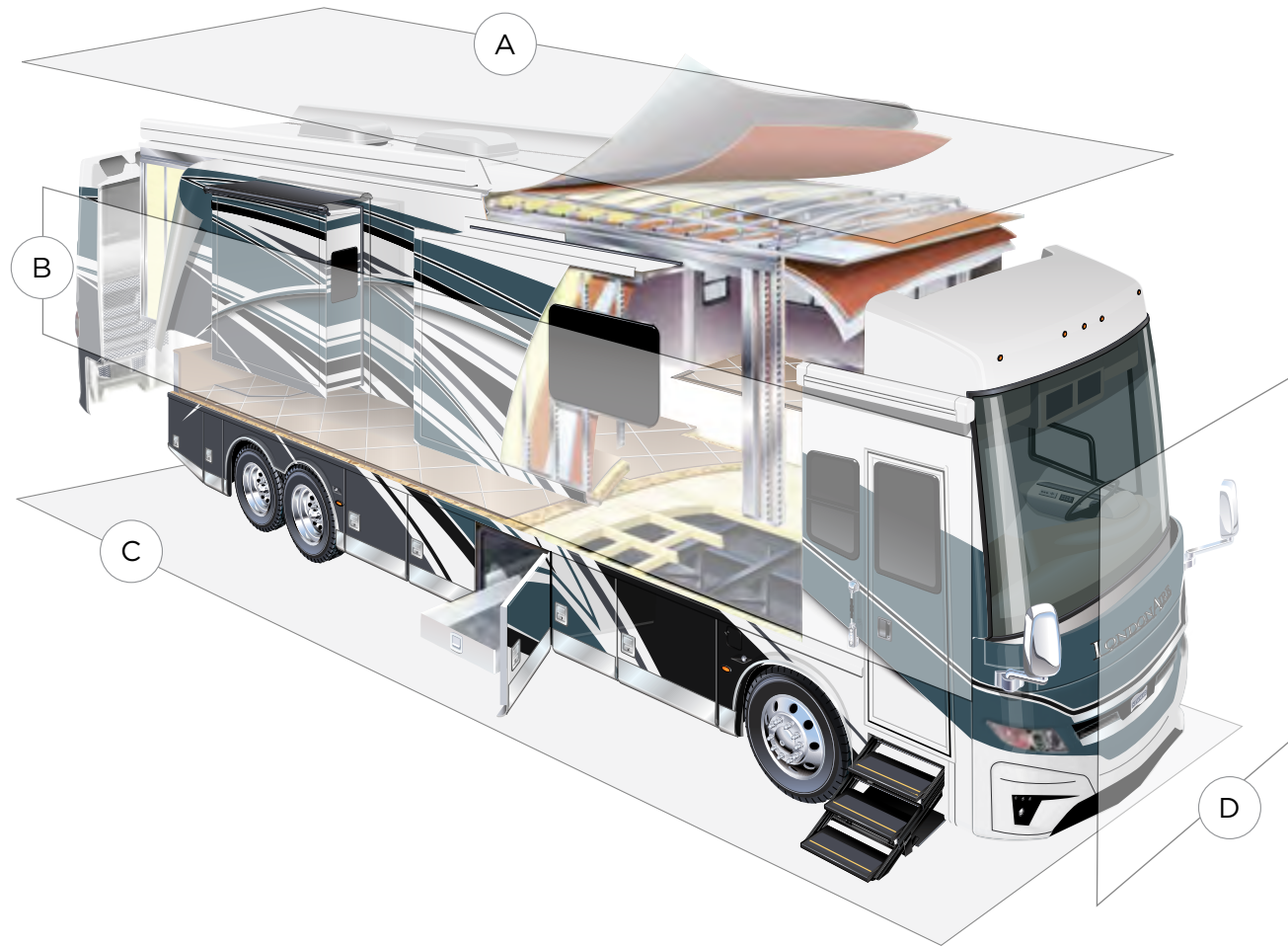

## A. ROOF

Fiberglass Roof  
 Batten Insulation  
 A/C Ducting  
 16" on Center Aluminum Rafter Framing  
 Kraft Paper Vapor Barrier  
 5/8" Bead Foam  
 3/16" Panel  
 Padded Vinyl Overlay

## B. SIDEWALL

Interior Wall Panel  
 5/8" Bead Foam  
 Kraft Paper Vapor Barrier  
 Batten Insulation  
 Composite One-Piece  
 Gelcoat Exterior Sidewall  
 Aluminum Framing

## C. FLOOR

Carpet/Tile  
 Carpet Padding  
 5/8" Floor Decking  
 Batten Insulation  
 16" on Center Wood Framing  
 Polyethylene Moisture Barrier

## D. EXTERIOR

15K BTU Penguin™ Heat Pump Central  
 Air Conditioner  
 One-Piece Bonded Windshield  
 Coated Aluminum Wheels  
 Frameless, Double-Pane,  
 Tinted Safety Glass Windows  
 Side-Hinged Baggage Doors with  
 Optional Pull-Out Tray

# The Newmar Customer Experience

The Newmar Difference™ goes beyond our industry-leading motor coaches to provide you with an unrivaled ownership experience.



## Quality from the Start

Every Newmar is crafted one at a time by folks who have spent an average of eight years building them. And each coach we assemble must undergo more than 1,000 tests and checks before ever leaving our factory.



## Carefully Selected Dealers

We view our dealership network in terms of quality, not quantity. Each of our dealers acts as a partner in our shared mission to exceed your highest of expectations, for an ownership experience that's second to none from day one.



## Everything in One Place

As a Newmar owner, you'll find resources specific to your coach through Newgle, an easy-to-use knowledge base that houses everything from user guides to technical support documents.



## Friends for Life

Meet fellow owners through the Newmar Kountry Klub, a top social club for RV travelers that hosts rallies and other special events throughout the U.S. and Canada.



## Seamless Service

When you join the Newmar family, we pair you with a dedicated service specialist with expert knowledge of your exact coach. Our service specialists guarantee dealer warranty authorizations within four business hours and ship all in-stock parts the same day, free of charge.



## Rock-Solid Protection

All models include a one-year/unlimited mileage limited warranty and a five-year, non-transferable structural warranty that covers your coach's superstructure in the event it fails to perform. Ask your Newmar dealer for more details.

*Our Partners*

The Newmar Difference™ begins with suppliers dedicated to providing our customers with unrivaled quality, comfort, and support.



*BASF*

The Coatings division of BASF is a global expert in the development and production of innovative and sustainable OEM and refinish coatings. Coatings by BASF—solutions beyond your imagination.



*Industrial Finishes*

Industrial Finishes has supported RV manufacturers for over four decades, offering paint products that deliver uncompromising quality and provide your coach with a true Masterpiece™ finish.



Driven By You

*Freightliner  
Custom Chassis*

Freightliner Custom Chassis are renowned for their exceptional ride, excellent maneuverability, advanced technology, and nationwide 24/7 factory-direct support.



*RIVERPARK*

From Samsung® 4K TVs and Xite Infotainment systems to Bose® soundbars and JBL and Infinity premium audio systems, RiverPark helps you experience a higher level of technology in your Newmar coach.



*Spartan Motors*

An American company with over 30 years of experience in designing and manufacturing the premier motorhome chassis, Spartan delivers superior performance, exceptional safety ratings, and industry-leading technology.



WHEN YOU KNOW THE DIFFERENCE<sup>SM</sup>